

ALL DIMENSIONS SHOWN IN MILLIMETRES UNLESS STATED OTHERWISE. DO NOT SCALE FROM THIS DRAWING. ALL DIMENSIONS TO BE VERIFIED ON SITE.

REVISION	AMENDMENTS	DATE	BY
V.0.00	Plan created	00/00/0000	AA

RETAIL INFORMATION		
DEPARTMENT	SQFT.	BAYS
GROUND FLOOR	32,211.54	N/A
MEZZANINE	13,765.73	N/A
GROUND FLOOR WAREHOUSE	2,086.24	N/A
MEZZANINE FLOOR WAREHOUSE	1,978.66	N/A

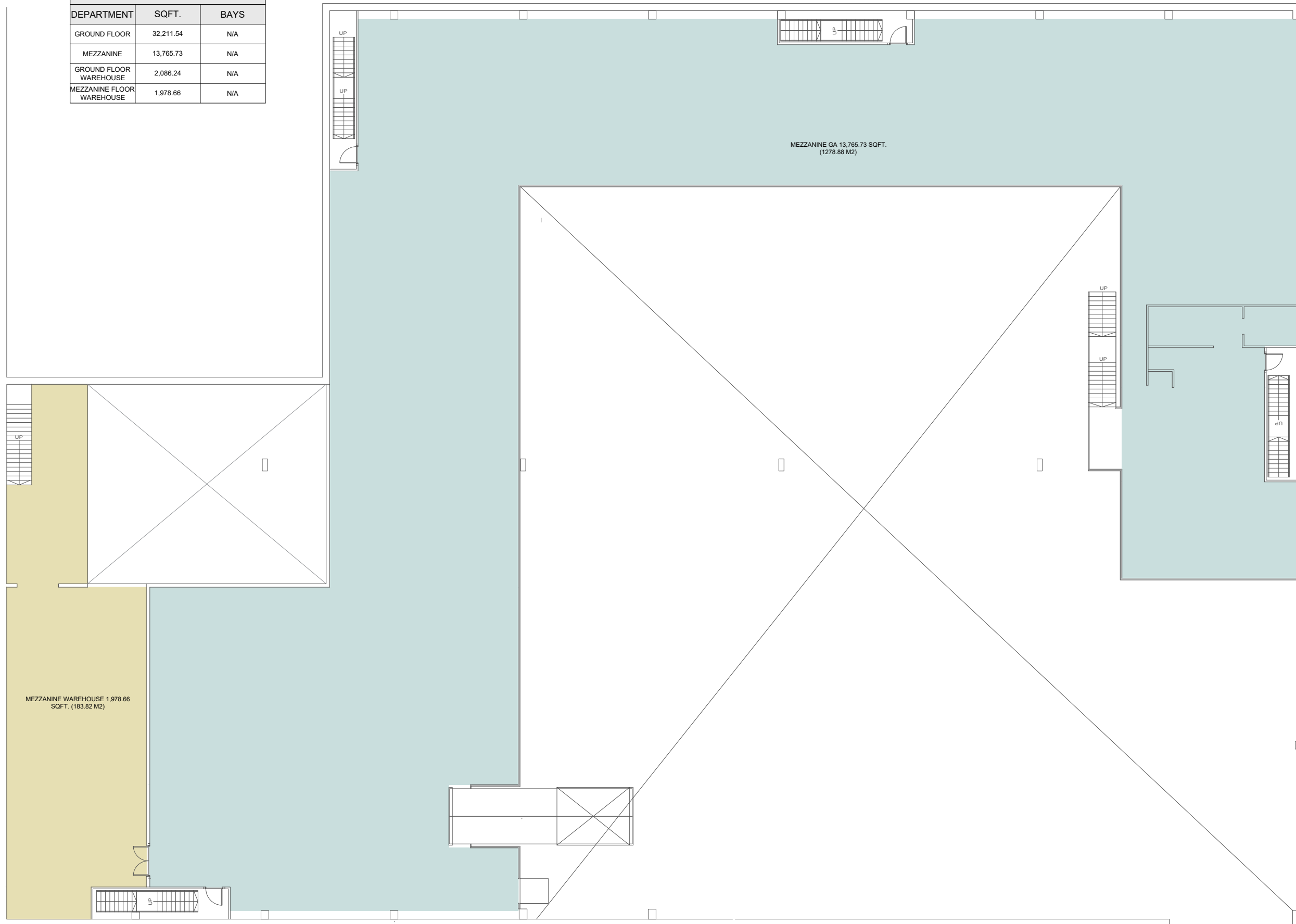

THIS DRAWING MUST NOT BE WHOLLY OR PARTIALLY COPIED, REPRODUCED OR MADE PUBLIC WITHOUT THE WRITTEN CONSENT OF:
SPACE PLANNING - THE RANGE

The Range
 HEAD OFFICE
 TAMAR HOUSE, THORNBURY ROAD,
 ESTOVER, PLYMOUTH, PL6 7PT
 TEL: 01752 725572

Plan _____
MEZZANINE
 Retail Square Foot _____
45977 SQFT.
 Location _____
EXETER_11.01
 Date Printed _____
21/11/2018 3:44 PM