

RETAIL INFORMATION		
DEPARTMENT	SQFT.	BAYS
GROUND FLOOR	32,211.54	N/A
MEZZANINE	13,765.73	N/A
GROUND FLOOR WAREHOUSE	2,086.24	N/A
MEZZANINE FLOOR WAREHOUSE	1,978.66	N/A

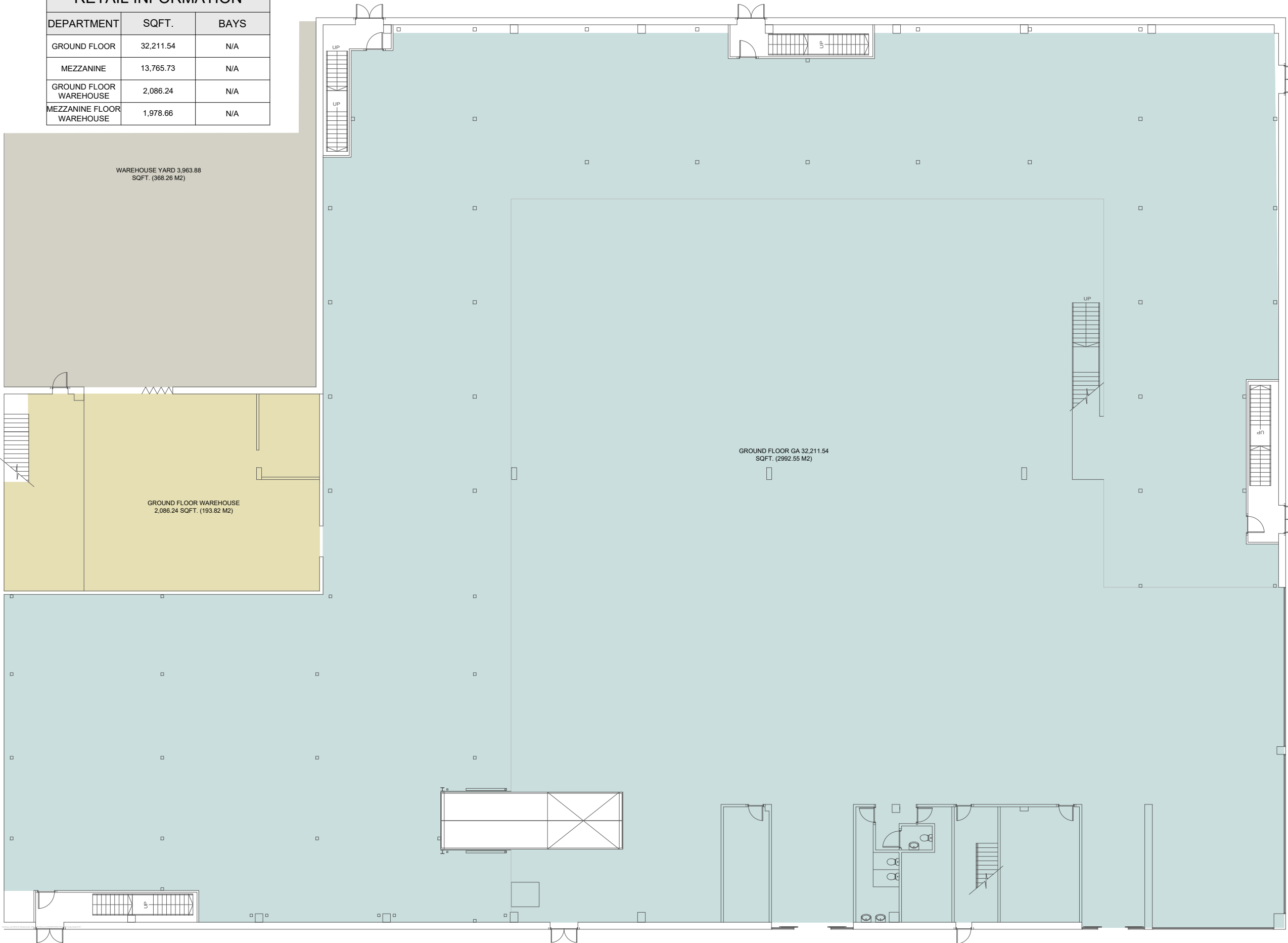

ALL DIMENSIONS SHOWN IN MILLIMETRES UNLESS STATED OTHERWISE. DO NOT SCALE FROM THIS DRAWING. ALL DIMENSIONS TO BE VERIFIED ON SITE.

REVISION	AMENDMENTS	DATE	BY
V.0.00	Plan created	00/00/0000	AA

THIS DRAWING MUST NOT BE WHOLLY OR PARTIALLY COPIED, REPRODUCED OR MADE PUBLIC WITHOUT THE WRITTEN CONSENT OF:  
**SPACE PLANNING - THE RANGE**

**The Range**  
 HEAD OFFICE  
 TAMAR HOUSE, THORNBURY ROAD,  
 ESTOVER, PLYMOUTH, PL6 7PT  
 TEL: 01752 725572

Plan  
**GROUND FLOOR**  
 Retail Square Foot  
**45977 SQFT.**  
 Location  
**EXETER\_11.01**  
 Date Printed  
**21/11/2018 3:44 PM**